



Technical Bulletin 2021-02

MRGNB Detail Requirement for Sleeper/Curb Installation or Removal in existing Modified Bitumen Membrane Systems

(June 8, 2021)

Intent – This technical bulletin is intended to provide clarity to all those involved in the modification of existing modified bitumen membrane system installations related to either the installation of new curbs and/or sleepers in existing modified bitumen membrane roof systems or the removal of existing curbs and/or sleepers and the subsequent repair of existing modified bitumen membrane systems.

The overriding goal is that the completed component installations or removals be consistent with typical MRGNB detail requirements. These requirements are based upon local experience and industry best practices, and are consistent with or exceed the requirements of the modified bitumen manufacturers participating in the Canadian roofing market.

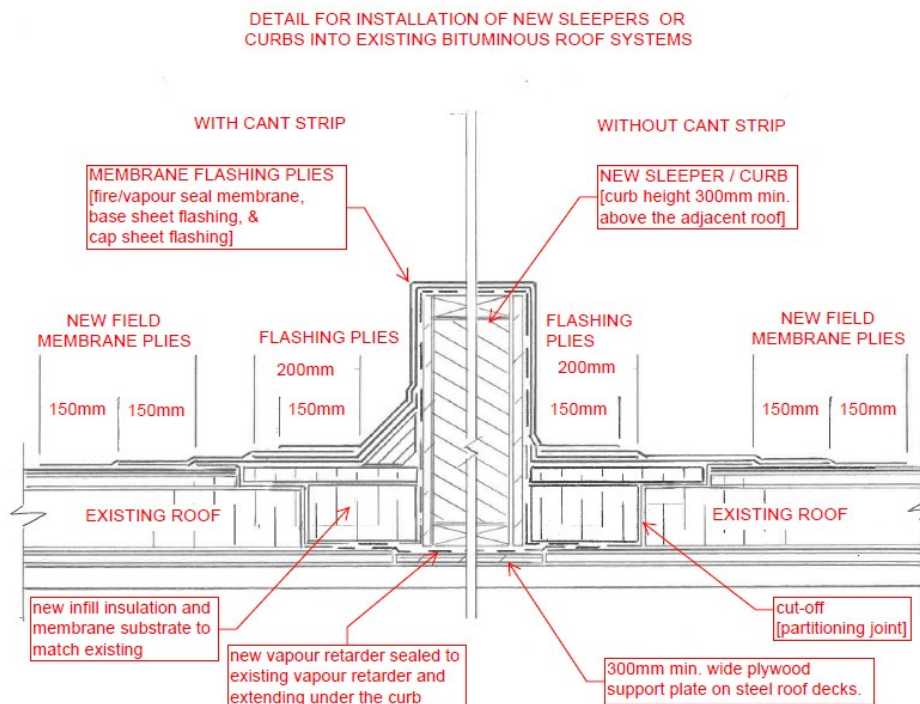



Master Roofers Guarantee of New Brunswick Ltd. La Garantie des Maitres Couvreur du Nouveau-Brunswick

1010 Fairville Blvd., Saint John, New Brunswick E2M 5T5 • Tel: (506) 652-7003 • 1 888 652-7003 • Fax: (506) 696-0380 • www.nbrca.ca

DETAIL FOR INFILL AND REINSTATEMENT OF AN EXISTING MODIFIED BITUMEN ROOF SYSTEM WHERE EXISTING EQUIPMENT SUPPORTS AND/OR CURBS HAVE BEEN REMOVED

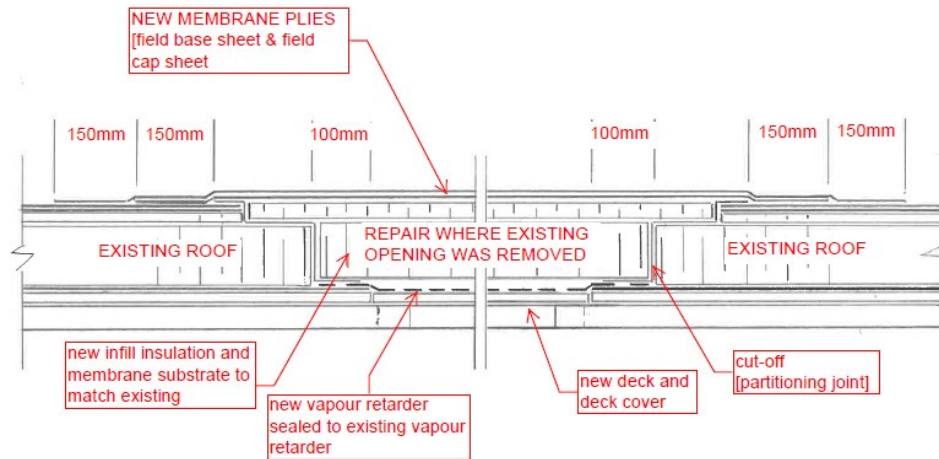

Notes:

All applications are to be consistent with MRGNB and the membrane manufacturer's requirements including:

1. Curb/sleeper blocking dimensions must accommodate the installation of the equipment onto the curb/sleeper with the modified bitumen membrane flashing plies installed (+20mm± on each face).
2. Surfaces to receive torch applied membrane applications are to be properly cleaned and prepared (granule embedment and/or primed) as required;
3. Surfaces to receive pressure sensitive membrane applications are to be properly cleaned and primed;
4. Surfaces to receive adhesive applications are to be properly cleaned and prepared as appropriate for the materials being used;
5. Deck cover, insulation, coverboard, base sheet, and/or composite panel coverboard-base sheet components are to be properly mechanically fastened and/or adhered as appropriate for the application, including membrane perimeter securement where required.
6. Membrane and membrane flashing materials and methods are to be consistent with MRGNB guarantee requirements and appropriate for the site specific application.
7. Leading edges of adhesive adhered or pressure sensitive cap sheet materials are to be hot air welded in accordance with the membrane manufacturers requirements.

END

